

**DESCRIPTION:**

PFC model number 5CL5086-100-CD-SS is a Combine filter with SMA female connectors in and out. All filters will be machined and silver plated to provide the highest possible Q.

**SPECIFICATIONS:**

- CENTER FREQUENCY: 5086 MHz
- 3dB BANDWIDTH: 100 MHz
- VSWR IN THE PASS BAND: 1.5:1 MAX.
- INSERTION LOSS (PASSBAND): <= 1.8 dB MAX.
- REJECTION FROM DC TO 2550 MHz: -65 dB
- REJECTION FROM 7578 TO 20000 MHz: -65 dB

**CONNECTORS:** SMA FEMALE CONNECTORS

- SIZE: 1.90" (L) x 0.50" (W) x 0.50" (H)
- WEIGHT: 1 OZ. TYP.

**ENVIRONMENTAL RATINGS:**

- TEMPERATURE: -55°C TO +85°C (OPERATING)  
-65°C TO +125°C (STORAGE)
- HUMIDITY: MIL-STD-202F, METHOD 103B COND. B
- SHOCK: MIL-STD-202F, METHOD 213B COND. B
- VIBRATION: MIL-STD-202F, METHOD 204D COND. B
- ALTITUDE: MIL-STD-202F, METHOD 105C COND. B
- SALT FOG: MIL-STD-202F, METHOD 107D COND. A
- FUNGUS: MIL-STD-810C, METHOD 508.2
- TEMPERATURE CYCLE: MIL-STD-202F, METHOD 107

REVISIONS		DESCRIPTION	DATE	APPROVED
ZONE	REV.	ORIGINAL RELEASE	6/19/00	

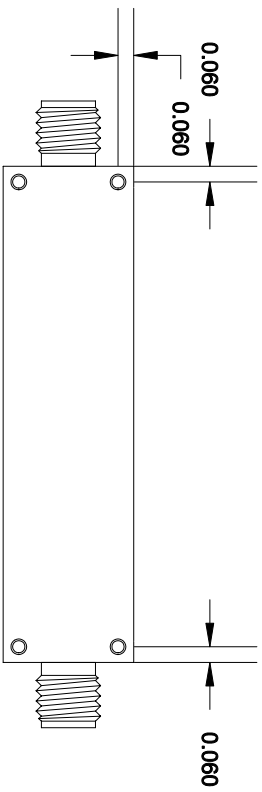
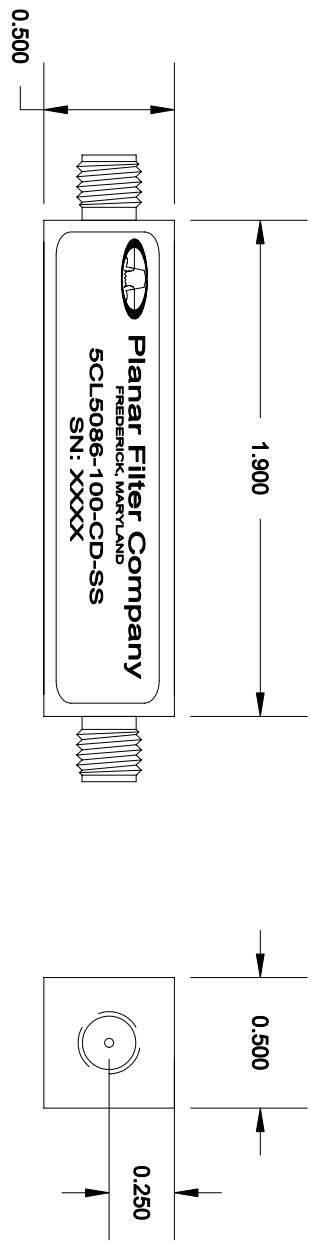

ALL DIMENSIONS ARE IN INCHES  
TOLERANCES:  
XXX ±0.010  
XXX ±0.005

NOTE: THE ABOVE SPECIFICATIONS ARE SUBJECT TO CHANGE OR REVISION

PART NO.	PF 60-172	TITLE	Planar Filter Company 7311G Grove Road, Fredrick, Maryland
APPROVALS	DATE	DATE	DATE
DRAWN	S. PALACIO	6/19/00	
CHECKED			
ISSUED			
SIZE	FSCM NO.	DWG NO.	REV.
A	1QJW0	155-0231	
SCALE	N/A	SHEET	1 OF 1