

**DESCRIPTION:**

PFC model number 5CL7G-700-CD-SFM is a Combine filter with SMA female connectors in and out. All filters will be machined and silver plated to provide the highest possible Q.

**SPECIFICATIONS:**

- CENTER FREQUENCY: 7 GHz
- 3dB BANDWIDTH: 700 MHz
- VSWR IN THE PASS BAND: 1.5:1 MAX.
- INSERTION LOSS (PASSBAND): <= 1.5 dB MAX.
- REJECTION: 8 POLE RESPONSE

**CONNECTORS:** SMA FEMALE/MALE CONNECTORS

- SIZE: 2.15" (L) x 0.60" (W) x 0.50" (H)
- WEIGHT: 1 OZ. TYP.

**ENVIRONMENTAL RATINGS:**

- TEMPERATURE: -55°C TO +85°C (OPERATING)  
-65°C TO +125°C (STORAGE)
- HUMIDITY: MIL-STD-202F, METHOD 103B COND. B
- SHOCK: MIL-STD-202F, METHOD 213B COND. B
- VIBRATION: MIL-STD-202F, METHOD 204D COND. B
- ALTITUDE: MIL-STD-202F, METHOD 105C COND. B
- SALT FOG: MIL-STD-202F, METHOD 107D COND. A
- FUNGUS: MIL-STD-810C, METHOD 508.2
- TEMPERATURE CYCLE: MIL-STD-202F, METHOD 107

REVISIONS		DATE	APPROVED
ZONE	REV.		
	-	7/10/01	

ORIGINAL RELEASE

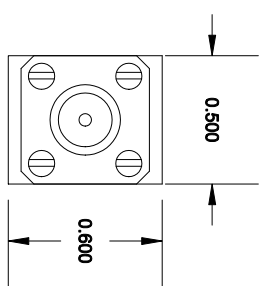
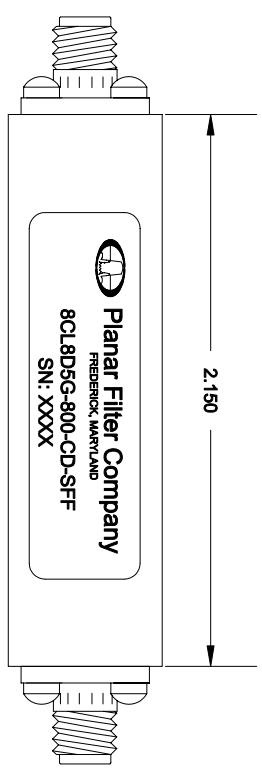

ALL DIMENSIONS ARE IN INCHES  
TOLERANCES:  
XXX ±0.010  
XXXX ±0.005

NOTE: THE ABOVE SPECIFICATIONS ARE SUBJECT TO CHANGE OR REVISION

PART NO.	155-0991	TITLE	Planar Filter Company 7311G Grove Road, Frederick, Maryland	
APPROVALS	DATE	SIZE	FSCM NO.	DWG NO.
DRAWN S. PALACIO	7/10/01	A	1QJW0	155-0991
CHECKED		SCALE	N/A	SHEET 1 OF 1
ISSUED				REV. -

OUTLINE DRAWING  
5CL7G-700-CD-SFM