



RF-LAMBDA

LEADER OF RF BROADBAND SOLUTIONS

RFWI28C

15W WR28 Waveguide Isolator 26.5 - 40GHz



Note: Photo is for illustration purposes only.
Please refer to the outline drawing.



Features

- High power handling capability up to 15W
- Wide band operation
- High isolation
- Low Insertion loss
- Stable performance over temperature

Typical Applications

- Aerospace and military applications
- Wireless Infrastructure
- Test and Measurement

Electrical Specifications, $T_A=25\text{ }^{\circ}\text{C}$

Parameter	Min	Typ.	Max	Units
Frequency Range	26.5-40			GHz
Insertion Loss		0.5	0.6	dB
Reverse Isolation (Note 1)	17			dB
VSWR		1.25	1.35	:1
Forward Power (CW)			15	W
Reverse Power (CW)			2	W
Rotation	Clockwise (Standard) Counter Clockwise (upon request)			
Input / Output Interface	COVER flat 4 holes			
Finish	conductive oxide			
Flange Type	UG599/U			
Case Material	Aluminum Alloy			
Note 1: Units which have a narrower frequency bandwidth can achieve higher isolation & lower insertion loss Bandwidth (5 ~10) % x Center Frequency (Isolation >19dB) Bandwidth (20~30) % x Center Frequency (Isolation >18dB) Bandwidth (40~60) % x Center Frequency (Isolation >17dB) Ask manufacturer for details				

15W WR28 Waveguide Isolator 26.5 - 40GHz



RF-LAMBDA

LEADER OF RF BROADBAND SOLUTIONS

RFWI28C

Environmental Specifications and Test Standards

Parameter	Standard	Description
Operational Temperature	MIL-STD-39016	-20°C~+60°C
Storage Temperature		-45°C~+85°C
Thermal Shock		1 Hour@ -45°C → 1 Hour @ +85°C (5 Cycles)
Random Vibration		Acceleration Spectral Density 6 (m/s) Total 92.6 RMS
Electrical & Temperature Burn In		Temperature +85°C for 72 Hours
Shock		1. Weight >20g, 50g half sine wave for 11ms, Speed variation 3.44m/s 2. Weight <=20g, 100g Half sine wave for 6ms, Speed variation 3.75m/s 3. Total 18 times (6 directions, 3 repetitions per direction).
Altitude	MIL-STD-883	Standard: 30,000 Ft (Epoxy Sealed Controlled Environment) Optional: Hermetically Sealed (60,000 ft. 1.0 PSI min)
Hermetically Sealed (Optional)		MIL-STD-883 (For Hermetically Sealed Units)

15W WR28 Waveguide Isolator 26.5 - 40GHz



RF-LAMBDA

LEADER OF RF BROADBAND SOLUTIONS

RFWI28C

Typical Performance Plots

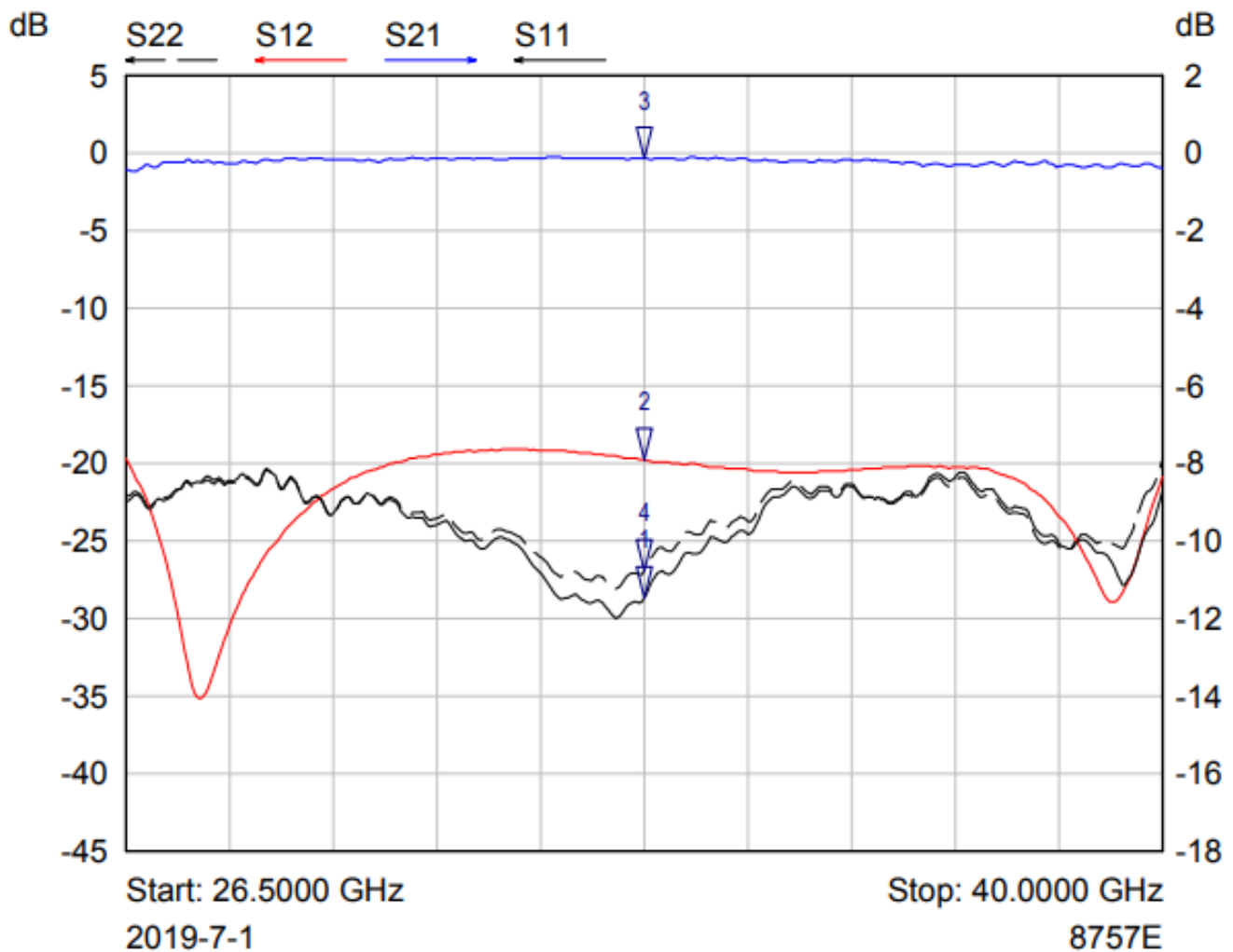

Mkr	Trace	X-Axis	Value	Notes
1 ▽	S11	33.2500 GHz	-28.71 dB	
2 ▽	S12	33.2500 GHz	-19.76 dB	
3 ▽	S21	33.2500 GHz	-0.13 dB	
4 ▽	S22	33.2500 GHz	-26.94 dB	

15W WR28 Waveguide Isolator 26.5 - 40GHz



RF-LAMBDA

LEADER OF RF BROADBAND SOLUTIONS

RFWI28C

Outline Drawing:

All Dimensions in mm [inches]

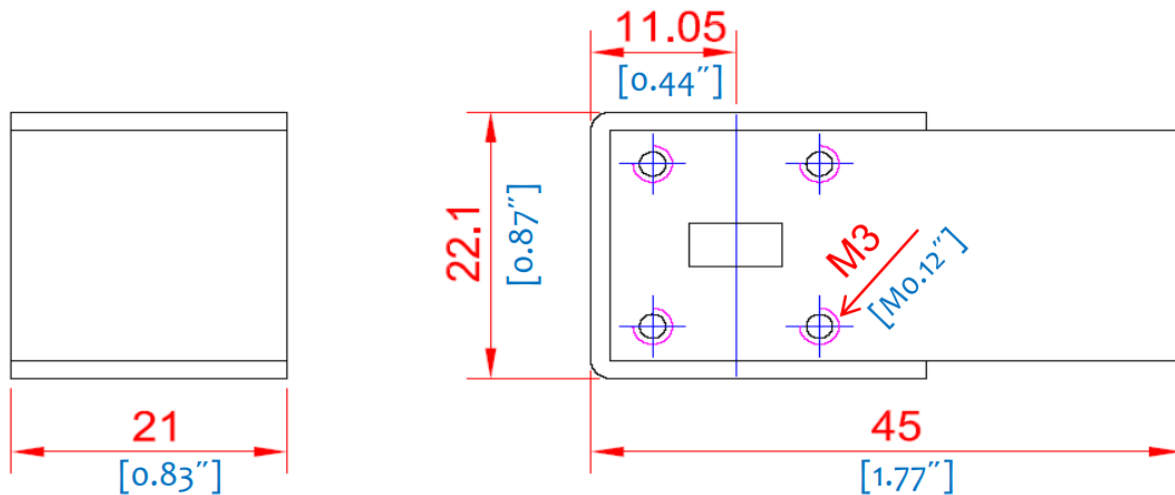

15W WR28 Waveguide Isolator 26.5 - 40GHz

Important Notice

The information contained herein is believed to be reliable. RF-Lambda makes no warranties regarding the information contained herein. RF-Lambda assumes no responsibility or liability whatsoever for any of the information contained herein. RF-Lambda assumes no responsibility or liability whatsoever for the use of the information contained herein. The information contained herein is provided "AS IS, WHERE IS" and with all faults, and the entire risk associated with such information is entirely with the user. All information contained herein is subject to change without notice. Customers should obtain and verify the latest relevant information before placing orders for RF-Lambda products. The information contained herein or any use of such information does not grant, explicitly or implicitly, to any party any patent rights, licenses, or any other intellectual property rights, whether with regard to such information itself or anything described by such information. RF-Lambda products are not warranted or authorized for use as critical components in medical, life-saving, or life sustaining applications, or other applications where a failure would reasonably be expected to cause severe personal injury or death.